



Michener

Peony Garden GUIDE

Nichols Arboretum Collections
University of Michigan
Ann Arbor, Michigan

"As more of the natural beauties
of Michigan are destroyed by
commercial exploitation,
the value of the Arboretum will
become more apparent and the
wise policy of the board of Regents
and the City in preserving and
developing it will be appreciated
more widely year by year."

Aubrey Tealdi, 1922
Director of the Arboretum and
Designer of the Peony Garden

**Mission of the
Nichols Arboretum
Peony Garden**

The Peony Garden is one
of a series of designated
historical areas in the
Arboretum. As such, the
Peony Garden shall be
managed to preserve and
promote the historical
knowledge and under-
standing of peony cultiva-
tion for the benefit of
future generations.

Thanks David
Allison

Thanks -
Susan Jak!
HJ

**Peony Garden
Guide**

Pat Whitaker
Ruth Whitaker

Nichols Arboretum Collections
University of Michigan
Ann Arbor, Michigan

1995, First edition, Published by the
Friends of Nichols Arboretum
and the
Peony Garden
Guide Committee

Henry Marton

Table of Contents

Welcome to the Peony Garden <i>Harrison Morton, Director</i>	3
Peony History and Horticulture <i>Charles Cares, Director Emeritus</i>	4
Peony Planting Illustration	7
Map Overview of the Peony Garden	8
How to Use this Guide	9
Peony Garden Bed Maps with Cultivar Lists	10 - 27
Peony Garden Inventory Key	28
Peony Garden Inventory of Cultivars	30 - 36
Arboretum Friends' Information	38
How to Order this Guide	38
Arboretum Staff and Committees	40
Map and Directions to Arboretum	41

Welcome to the Peony Garden

This Garden is one of the historical treasures of the Arb – a beloved community institution. Generations of students and townspeople have enjoyed the Garden since it opened for the University's 1927 summer commencement.

In keeping with our dedication to education, I have encouraged documentation of the horticultural and historical facts about this garden. Research and collection activities are ongoing. This booklet is a working document, and is as accurate as possible at this time. It will be updated in the future as we acquire and plant missing cultivars.

We are restoring the old roses that once grew on a fence around the Peony Garden. While we will not restore the chain link fence, we are planting the roses on the north side of the garden along the top of the bank. As the Arboretum nears its 90th anniversary, we are also restoring its educational mission.

Many other little known treasures in the Arboretum await your discovery: the Appalachian Glen with its rhododendrons and related plants; the Dow Prairie; the Lilacs; and more. To pass along this knowledge and carry on research, we are establishing an educational center near the Peony Garden just outside the gates. For more information, please call me.

Now, enjoy the Garden . . .



Harrison L. Morton, *Director*

Peony History and Horticulture

The Peony Garden at the Nichols Arboretum was established in 1927 by Aubrey Tealdi, the chairman of the Landscape Architecture Department and the Arboretum's first director. Many of the original plants were given to Professor Tealdi by Dr. Walter Upjohn of Kalamazoo, an avid peony amateur, but better known as the founder of the Upjohn Corporation.

The Nichols Peony Collection was outstanding for a number of years and then declined after some years of neglect. Around 1987, a decision was made to restore the gardens, and to the extent possible, reestablish the original historic collection. The Arboretum has been aided notably in this task by a generous grant from the Ann Arbor Chapter of the Woman's National Farm and Garden Association and by Brook Lodge Gardens, which donated many varieties from the original Upjohn collection that were lost from the Arboretum's garden.

Today the Peony Garden is one of the outstanding historic collections in the region, containing over 260 "old" varieties introduced to the trade between 1807 and 1948 with most between 1907 and 1925. Restoration and preservation efforts continue and alone could be justified by a single glimpse of the annual spectacle of over 700 peonies in bloom.

A Word about Peonies

Herbaceous Peonies, so greatly admired and commonly recognized and planted, are principally derived from crosses and selections of two species. The first is *Paeonia officinalis*, a native of central Europe. This is the Peony of

mythology and of early medicine. The second is *Paeonia lactiflora*, sometimes called the Chinese Peony. It is a native of the central regions of Siberia and central to Eastern Asia. It was introduced into Europe in the mid-eighteenth century. Peonies are not mentioned in American horticultural literature until 1800, but it is certain that they were here decades earlier.

Peonies do best on a sandy clay or silt clay soil, but are easily grown in almost any soil as long as it is well drained. They do not tolerate poorly drained soil. Plants do best in full sunlight, but they will stand a moderate amount of shade. They should be planted away from trees and shrubbery that compete for water and nutrients.

Planting Peonies

September is the best time to divide existing plants or to plant newly acquired roots in Michigan. This permits new divisions to develop feeder roots before the advent of severe weather. Farther south, October would be as satisfactory. Peonies planted in spring, unless pot grown, sometimes fail because the root development does not keep pace with top growth.

If at all convenient, prepare the planting site in advance of actual planting (see illustration on page 7). A generous amount of well-rotted animal manure is beneficial to Peonies. It is best applied during this early preparation period. It should be mixed well with soil. Place a layer of soil above the fertilized zone so that roots of the peonies do not come in contact with the manure. Preparing the bed in advance permits the manure and chemical elements to bond with soil particles, lessening the chance of root injury, and letting the soil

settle before roots are placed. Some gardeners recommend placing a small handful of commercial fertilizer mixed well with topsoil at the bottom of the plant hole.

Set the new division in an upright position in a hole wide enough and deep enough to prevent the roots from crowding. In Michigan's soils, the buds should be covered by a maximum of two inches of soil. Plants placed too deeply sometimes fail to bloom. Water the new plant well so that the soil settles around the roots eliminating air pockets.

Care and Maintenance

A soil test is useful to determine the precise amount and fertilizer formulation needed. Usually, however, a handful of a commercial fertilizer, such as 10-10-10, will be adequate to keep plants vigorous. Avoid placing any fertilizer, even well-rotted manure directly over the crown, as it may injure developing shoots. Watering is important. Newly set plants should be watered to a depth of eight to ten inches during the first summer after planting. A summer mulch of old wood chips or other suitable material placed at a depth of two to three inches will conserve moisture and discourage weeds.

In areas of severe winter weather, it is prudent to provide some winter protection, especially the first year after planting. Mound a shovelful or two of earth over the top of the plant. This is useful in a couple of ways. The mound allows excess moisture to drain away from the plant and it also provides protection from alternate freezing and thawing. After the ground is frozen, a mulch placed over the plant will keep the soil frozen and prevent heaving. Marsh hay, straw, evergreen boughs or leaves will all serve this

purpose. The mulch and soil mound should be removed before spring growth begins.

Peonies are generally free of plant diseases. The most common and serious are two fungal diseases, *Botrytis* blight and *Phytophthora* blight. Each requires good sanitation practice to prevent infection and spread. Spent flowers should be removed before seeds drop within the plant. Stems and foliage of the plants should be removed from the garden and destroyed each fall after they have been killed by hard frost. *Botrytis* can be controlled by applying Captan, Benlate, or Bordeaux mixture according to the manufacturer's directions. *Phytophthora*, a more destructive but less common disease, can be controlled with a chemical sold under the trade names of Dithane M-45 or Manzate 200.

PLANTING DETAIL

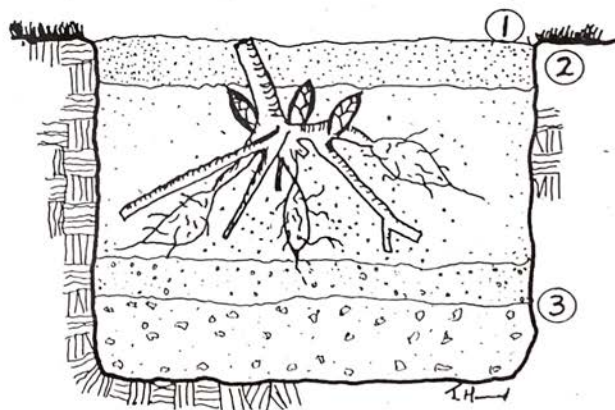

- 1) Dig hole wide and deep enough to prevent crowding of peony roots.
- 2) Provide 1" to 2" for maximum cover over buds.
- 3) Place 3" of rotted manure well mixed with soil, and cover it with 2" topsoil mixed with approximately a handful of fertilizer e.g. 6:12:12.
OR
Use 5" topsoil mixed with a 1/2 Lb. fertilizer (e.g. 6:12:12) thoroughly mixed.

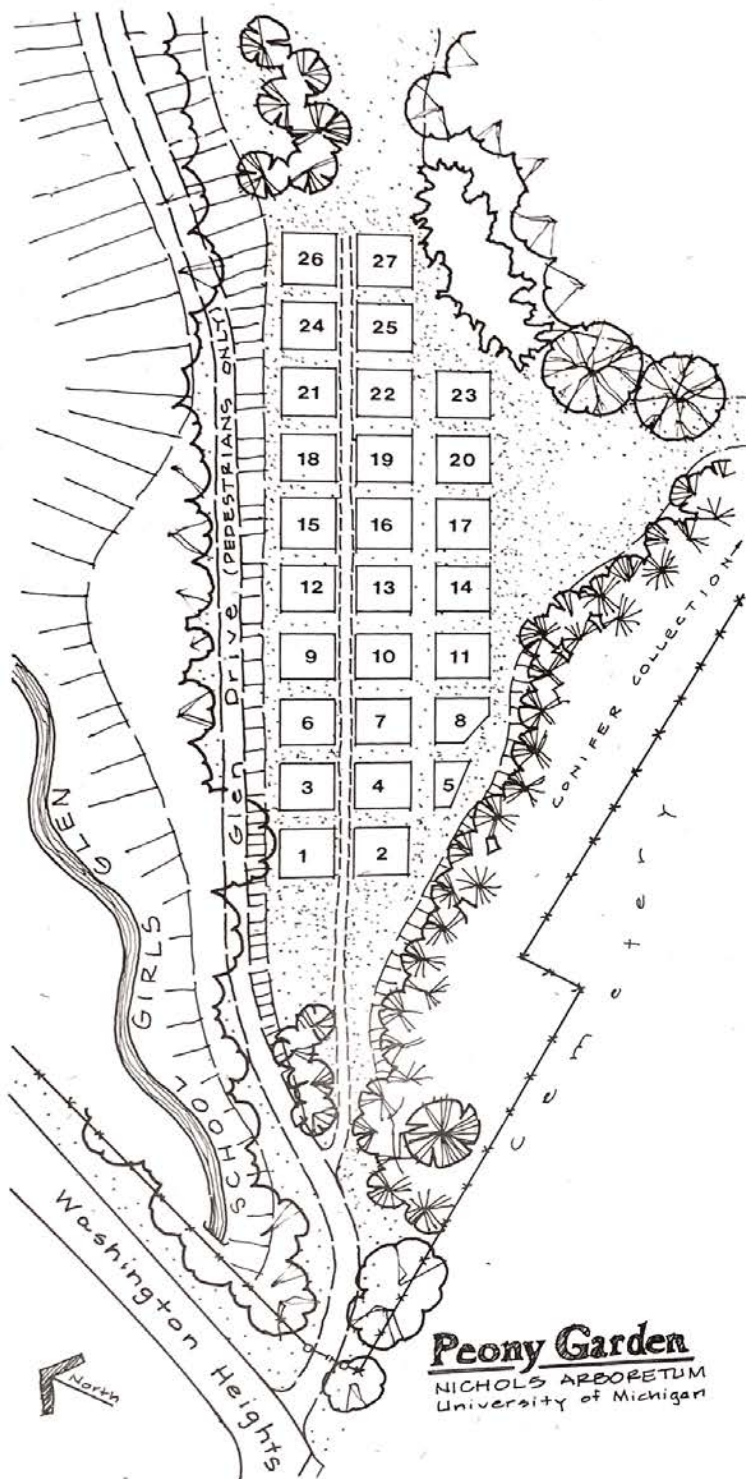

How to Use this Guide

Enter and enjoy the Peony Collection! We hope this Guide will serve a wide range of Peony Garden visitors from the casual observer to the learned horticulturist.

Please take a moment to get oriented to the Garden. The Map on the opposite page presents the overall organization. There are 27 Beds, and each has a permanently assigned Bed Number. This number is inscribed on Bed Markers in each corner of each Bed. Find a sample marker and note its location and appearance.

The Bed Maps in this section are arranged numerically from Bed 1 to Bed 27. Bed 1 is located at the west end of the Garden, known as the Washington Heights end. Bed 2 is to the right, then 3 begins a new row as you progress across rows and up the Map ending with Bed 27.

Now turn the page to Bed 1. On the left is a diagram of the Bed with the following information:

166 = Inventory Number (permanently assigned for each existing, identified Peony cultivar).

? = Question Marks indicate an existing, unidentified plant.

X = Open Space in the bed.

On the right page, you will find the Inventory Number. This will give you the Name, Color and Form of the cultivar. Note that Color is presented only in this Bed Map section, and is the same as used by the American Peony Society.

Please turn to the Peony Inventory starting on page 30 for detailed definitions and a complete alphabetical listing of all identified Peony varieties found in the Garden.

238 238 238 98 98 98

X X 183 X X X

356 49 49 49 49 49

194 356 194 194 185 185

166 194 166 306 65 65

1

64 64 100 100 64 64

127 ? ? X 136

127 127 377 284 284

7 7 7 7 377

306 185 185 X 100

2

344 344 269 269 102 102

253 253 253 253 309 309

18 18 137 X 57 57

344 344 354 354 372 372

292 292 138 138 138 138

3

Inv# / Name / Color / Form

Bed 1

166	Krinkled White	pink	single
194	Luetta Pfeiffer	pink	single
306	Pico	white	single
65	Duchesse de Nemours	white	double
356	Summer Day	white	double
185	Le Jour	white	single
49	Clairette	pink to white	single
183	Laura Dessert	pink to white	double
238	Mme. Calot	white	double
98	Ferdinand Stolickza	blush white	Japanese

Bed 2

306	Pico	white	single
185	Lejour	white	single
100	Festiva Maxima	white	double
7	Albiflora, the Bride	white	single
377	Walter Morgan	white	double
127	Grandiflora nivea plens	pink to white	double
284	Nanette	blush white	double
136	Hazel Kinney	white	double
64	Duchess of Portland	pink	single

Bed 3

292	Octavie Demay	white	double
138	Helen Robertson	lilac white	double
344	Simonne Chevalier	pink	double
354	Standard Bearer	pink	double
372	Victory Chateau Thierry	pink	double
18	Arlequin	white	Japanese
137	Helen	pink	single
57	Early Daybreak	white	single
253	Mme. Joanne Sallier	rose	double
309	Pink Delight	white	single
269	Mr. Thim	carmine red	single
102	Flag of War	red	single

19	19	219	219	219	X
188	188	X	X	326	326
157	157	?	?	15	15
72	72	262	262	262	262
70	70	109	109	245	245

4

361	361	X	X
189	189	163	163
X	X	X	
365	365	?	
64	64	?	

5

35	35	291	291	291	291
35	35	332	332	332	124
184	184	156	156	247	247
?	?	247	247	?	?
156	156	4	4	172	193

6

Inv# / Name / Color / Form

Bed 4

70	Edith Lyttleton	pink	double
109	Frankie Curtis	white	double
245	Mme. Duce	pink	double
72	Edulis Superba	pink	double
262	Mons. Jules Elie	pink	double
157	Judge Berry	pink	double
15	Anemoneflora Rubra	red crimson	double
188	Lora Dexheimer	red	double
326	Richard Carvel	red	double
19	Arturus	dark red	single
219	Meteor	red	single

Bed 5

64	Duchess of Portland	pink	single
365	Tokio	pink	Japanese
189	Lord Kitchener	red	double
163	Kelway's Glorious	white	double
361	The Moor	red	single

Bed 6

156	Jubilee	white	double
4	Adelaide E. Hollis	white	double
172	La Lorraine	white	double
193	Luella Shaylor	white	Japanese
247	Mme. Emile Lemoine	white	double
184	Le Cygne	white	double
35	Betty Blossom	white	double
332	Rose Shaylor	pink	double
124	Golden Dawn	white-yellow	double
291	Nymphaea	white	double

315 315 252 252 341 341

176 176 252 252 341 341

107 107 107 107 1 X

175 175 274 175 319 319

175 ? 175 175 319 319

7

274 274 120 120 X X

261 261 40 40 X 348

174 174 X X X

174 174 302 302 302

224 224 169 169

8

258 258 118 118 206 206

258 258 118 118 93 93

299 299 297 297 X X

297 297 X X 370 370

214 214 29 29 149 149

9

Inv# / Name / Color / Form

Bed 7

175	La Tendresse	white	Japanese
319	Queen of the Belgians	white	single
274	Mrs. Edward Harding	white	double
107	Frances Willard	pink to white	double
1	A. B. C. Nicholls	white w/ pink	double
176	La Tulipe	flesh pink	double
252	Mme. Guyot	cream white	double
341	Secretary Fewkes	white	double
315	Primevere	white	double

Bed 8

224	Mildred May	white	semi-double
169	La Fiancee	cream	double
174	La Rosiere	white	semi-double
302	Philippe Rivoire	red	double
274	Mrs. Edward Harding	white	double
261	Mons. Depont	white	double
40	Boule de Neige	white	double
348	Some Ganoko	red	Japanese
120	Gisele	cream	double

Bed 9

214	Mary Woodbury Shaylor	flesh white	double
29	Baroness Schroeder	white	double
149	James Kelway	pale pink	double
297	Pallas	pink	semi-double
370	Venus	pink	double
299	Pasteur	pink	double
258	Mme. Savreau	cream	Japanese
118	Ginette	pink	double
93	Fanny Crosby	yellow/pink	Japanese
206	Marie d'Hour	pink	double

? ? 324 324 303 303
 317 317 177 177 177 256
 179 179 179 179 330 330
 162 162 162 162 207 207
 305 305 378 378 378 378

10

229 229 368 368 80 80
 296 296 366 366 80 80
 296 256 229 229 298 298
 244 244 254 254 230 230
 296 X 254 254 74 74

11

14 359 359 359 314 314
 79 79 314 314 73 73
 234 234 308 308 75 75
 79 79 16 16 89 89
 334 334 334 334 359 359

12

Inv# / Name / Color / Form

Bed 10

305	Phyllis Kelway	pink	single
378	Welcome Guest	pink	double
162	Katherine Havemeyer	pink	double
207	Marie Jacquin	pale pink	semi-double
179	Lady Emily	pink	double
330	Rosa Bonheur	pink	double
317	Princess Irene	pink	
177	Lady Alexandra Duff	blush	double
256	Mme. Lemoinier	pink	double
324	Rei-Kai-Zan	deep pink	Japanese
303	Philomele	pink	anemone

Bed 11

296	Opal	pink to white	double
254	Mme. Jules Dessert	flesh white	double
74	Eileen Kelway	white	Japanese
244	Mme. de Verneville	white	double
230	Mlle. Jeanne Riviere	pink, yellow	double
256	Mme. Lemoinier	pink	double
229	Miss Salway	lilac white	double
298	Paradise	pink	double
366	Tourangelle	light pink	double
80	Ella Christine Kelway	lavender flesh	double
368	Triomphe de l'Exposition de Lille	light pink	double

Bed 12

334	Rosy Dawn	white	single
359	Suzette	rose pink	double
79	Ella Christiansen	pink	double
16	Archie Brand	seashell pink	double
89	Eugenie Verdier	rose pink	double
234	Mme. Auguste Dessert	pink	double
308	Pink Baroness Schroeder	pink	double
75	Elfin Pink	pink	single
314	Pride of Essex	pink	double
73	Edwin C. Shaw	pink	double
14	Andrew Muehlig	dark pink	double

336	336	167	167	266	266
336	336	?	?	77	77
380	380	104	104	77	77
32	32	20	20	?	?
380	380	222	222	164	164

13

X	115	90	90	333	115
376	376	92	92	333	333
89	89	89	89	205	205
325	325	150	150	54	54
173	173	339	339	363	363

14

23	23	187	187	381	381
23	23	187	187	322	322
X	X	165	165	387	387
54	195	195	281	X	X
317	317	338	338	338	338

15

Inv# / Name / Color / Form

Bed 13

380	Will McClelland	pink	double
222	Mignon	pink	double
164	Kelway's Queen	pink	double
32	Belisaire	light pink	double
20	Asa Gray	pale pink	double
104	Floral Treasure	pink	double
77	Elisa	pink	double
336	Ruth Brand	pink	double
167	L'Etincelante	pink	single
266	Moses Hull	pink	double

Bed 14

173	La Perle	pink	double
339	Sarah Carstensen	pink	double
363	Therese	pink	double
325	Reine Hortense	pink	double
150	James R. Mann	pink	double
54	Coronation	pink	double
89	Eugene Vedier	rose pink	double
205	Marie Crousse	pink	double
376	Walter Faxon	shell pink	double
92	Exquisite	pink	semi-double
333	Rosette	pink	double
115	Georgiana Shaylor	pink	double
90	Euphemia	lilac rose	double

Bed 15

317	Princess Irene	pink	
338	Sarah Bernhardt	pink	double
54	Coronation	pink	double
195	Mable L. Franklin	pink	double
281	Mrs. Livingston Farrand	pink	double
165	King of England	red	Japanese
387	Westerner	pink	Japanese
23	Augustin d'Hour	red	double
187	Longfellow	red	double
322	Rachel	red	double
381	William F. Turner	red	double

X X 263 263 X X
 111 111 46 46 46 46
 384 384 371 371 160 160
 97 97 97 97 160 160
 351 351 301 301 301 301

16

33 44 44 44 44 44
 209 209 212 33 209 209
 209 212 131 131 5 5
 59 59 182 182 223 223
 365 365 209 209 22 22

17

190 190 196 196 141 141
 112 112 X X 151 151
 125 125 105 105 105 105
 379 379 125 125 360 360
 379 379 147 147 X X

18

Inv# / Name / Color / Form

Bed 16

351	Souv. de Louis Bigot	pink	double
301	Petite Renee	carmine pink	Japanese
97	Felix Crousse	crimson red	double
160	Karl Rosenfield	red	double
384	Winifred Domme	red	double
371	Victorie de la Marne	purplish red	double
111	Fuyajo		Japanese
46	Cherry Hill	red	double
263	Mons. Martin Cahuzac	white	semi-double

Bed 17

365	Tokio	pink	Japanese
209	Marquis C. Lagergren	cherry red	double
22	Auguste Dessert	pink	double
59	Departing Sun	red	single
182	Lamartine	pink	double
223	Mikado	red	Japanese
212	Mary Brand	red	double
131	H. F. Reddick	dark crimson	double
5	Adolphe Rousseau	red maroon	double
33	Benjamin Franklin	white	double
44	Charles McKellip	bright red	double

Bed 18

379	White Lady	white	Japanese
147	Isoline	white	double
125	Grace Loomis	white	double
360	Sylviane	white	double
105	Florence Nightingale	white	double
112	Galathee	white	double
151	Jeanne Gaudichau	pink	double
190	Louisa Brand	light pink	double
196	Madelon	shell pink	double
141	Henry Avery	light pink	double

25	25	63	63	63	63
25	25	204	99	99	X
204	99	99	99	27	27
99	99	265	265	30	30
27	X	271	271	30	30

19

208	208	55	55	55	55
375	9	375	X	148	148
50	50	327	327	X	X
34	34	208	208	X	X
50	50	208	208	12	12

20

328	328	155	155	153	153
225	225	81	81	117	117
?	?	81	81	139	139
346	346	53	53	139	139
340	340	282	282	287	287

21

Inv# / Name / Color / Form

Bed 19

27	Avalanche	blush white	double
271	Mrs. A. M. Brand	white	double
30	Bayadere	white	double
99	Festiva	cream white	double
265	Moon of Nippon	white	Japanese
204	Marie	pale pink	double
25	Aurore	pink	double
63	Duc de Wellington	white	double

Bed 20

50	Claude Gellee	white	double
208	Marie Lemoine	white	double
12	Alsace Lorraine	pure white	double
34	Bertrade	white	double
327	Richardson's Perfection	pink	double
375	W. F. Christman	blush white	double
9	Alfred de Musset	flesh white	double
148	James Boyd	pink	double
55	Couronne d'Or	white	double

Bed 21

340	Sarah K. Thurlow	white	double
282	Myrtle Gentry	rosy white	double
287	Nick Shaylor	light pink	double
346	Solange	buff white	double
53	Cornelia Shaylor	light pink	double
139	Helen Wolaver	seashell pink	double
81	Elwood Pleas	pink	double
225	Milton Hill	pink	double
117	Gigantea	pink	double
328	Rinhosen	purplish pink	Japanese
155	John Richardson	pink	double
153	Jeannot	pink	double

85 85 236 236 133 133

83 83 202 202 39 39

145 145 246 246 39 39

24 24 192 192 24 24

386 386 192 192 24 24

22

203 203 ? 313 217 217

26 X 203 203 217 217

6 6 273 273 304 304

? ? 191 191 47 47

320 320 X X 47 47

23

130 130 267 267 51 51

X X 48 48 278 278

186 186 186 186 48 48

210 210 227 227 227 227

275 275 X X 235 235

24

Inv# / Name / Color / Form

Bed 22

386	Yeso	white	Japanese
192	Lucy E. Hollis	pink	double
24	Aureolin	pink	Japanese
145	Innocence	pink	Japanese
246	Mme. Emile Galle	pink	double
39	Blanche Turner	white	double
83	Entente Cordiale	pink	double
202	Marguerite Gaudichau	pink	double
85	Etta	pink	double
236	Mme. Boulanger	pink	double
133	Hansina Brand	pink	double

Bed 23

320	R. P. Whitfield	pink	double
47	Chestine Gowdy	pink	double
191	Loveliness	pink	double
6	Albert Crousse	light pink	double
273	Mrs. C. S. Minot	flesh pink	double
304	Pheobe Cary	pink	double
26	Auten's Pride	pink	double
203	Marguerite Gerard	pink	double
217	Maud L. Richardson	pink	double
313	President Wilson	pink	double

Bed 24

275	Mrs. F. D. Roosevelt	pink	double
235	Mme. Benoit Riviere	pink	double
210	Martha Bulloch	pink	double
227	Miriam	pink	double
186	Livingstone	pink	double
48	Claire Dubois	rose pink	double
278	Mrs. John M. Kleitsch	violet rose	double
130	H. A. Hagen	dark pink	double
267	Mr. G. F. Hemerik	pink	Japanese
51	Clemenceau	pink	double

94	94	94	94	158	158
X	43	95	95	43	142
353	353	171	171	142	142
126	126	353	353	136	136
X	X	248	248	248	248

25

128	128	143	143	335	335
128	128	143	143	335	335
268	268	123	123	X	38
289	289	289	289	56	56
X	X	66	66	56	56

26

250	250	239	239	312	X
250	250	239	239	146	146
52	52	52	52	228	228
228	X	113	113	198	198
385	385	385	385	198	198

27

Inv# / Name / Color / Form

Bed 25

248	Mme. Forel	pink	double
126	Grandiflora	pink	double
353	Splendida	pink	double
136	Hazel Kinney	white	double
171	La France	pink	double
142	Henry M. Vories	pink	double
43	Celestial	rose pink	double
95	Faustine	pink	double
94	Faribault	rose pink	double
158	Jules Calot	pink	double

Bed 26

66	Duke of Devonshire	rose	double
56	David Harum	red	double
289	Nippon Brilliant	red	Japanese
268	Mr. L. van Leeuwen	red	double
123	Gloire de Touraine	red	double
38	Blanche King	dark pink	double
128	Grover Cleveland	red	double
143	Hiscite Gawa	pink	Japanese
335	Rubra Superba	red	double

Bed 27

385	Winnikenni	pink	double
198	Marechal Vaillant	mauve pink	double
228	Mischief	pink	single
113	Geishe	pink	Japanese
52	Constant Devred	purple red	double
250	Mme. Gaudichau	red	double
239	Mme. Camille Bancel	pink	double
146	Inspecteur Lavergne	red	double
312	President Lincoln	red	single

Peony Garden Inventory Key

Inv# = Inventory Number

These numbers are assigned (starting with one) to an alphabetical listing of all Peony cultivars on Nichols Arboretum Peony Garden maps up to and including 1949. (1927, 1932 and 1937, Tealdi and Moody); and 1949, Whittemore and Moody. The complete inventory includes 387 cultivars. At this time, only 260 varieties actually exist in the garden, accounting for gaps in the inventory numbering.

Name = Variety Name

As listed in the American Peony Society publication, Peonies – Favorites of Greek Gods and Chinese Emperors – A History of Peonies and Their Origins, 1976.

Yr = Year

Year introduced into the Trade as reported in above publication.

Bed = Bed Number

The Peony Garden consists of 27 beds which are approximately 25 feet square (except for irregular beds 2, 5 and 8). Each bed has a number found on markers in each of its corners. Numbering starts at the west end (Washington Heights entry) and progresses to the east.

Form

Peonies are classified by the varying forms that the flower parts take. There are four distinct types found in the Peony Garden, although the "double" form predominates and includes over 200 varieties.

S = Single: One or two rows of outer guard petals and a yellow center of stamens.

J = Japanese: Five or more guard petals and a center of modified stamens bearing abortive (imperfectly formed) anthers, referred to as stamenoides.

SD = Semi-Double: Several rows of petals and a yellow center. Five or more guard petals, center of broad petals with many pollen-bearing stamens intermixed. Flowers have a more open appearance, so that the stamens and pistils are exposed in the open blossom.

D = Double: Large, full flowers composed of all petals. Usually the most fragrant. Five or more guards, center of stamens and carpels more or less fully transformed into petals forming full flower.

Season

An estimate of the bloom season for each cultivar is based on the total length of bloom season for all cultivars. In the Ann Arbor area, the bloom season is eight weeks, from the third week in May to the second week in July. The average peak bloom time is the second week in June. The following categories are used:

E = Early: First three weeks of season

M = Mid: Middle two weeks

L = Late: Last three weeks

Scent

Assessments of scent are largely subjective, depending on the beholder, and vary widely from unpleasant odor to intoxicating fragrance. For this listing, the American Peony Society descriptors have been edited and only two categories have been noted:

F = Fragrant

VF = Very Fragrant

Peony Garden Inventory

Inv# / Name / Yr / Bed / Form / Season / Scent

1	A. B. C. Nicholls	1937	7	D L		
4	Adelaide E. Hollis	1907	6	DM		
5	Adolphe Rousseau	1890	17	DM		
6	Albert Crousse	1893	23	D L F		
7	Albiflora, the Bride	1902	2	S E		
9	Alfred de Musset	1885	20	DM		
12	Alsace Lorraine	1906	20	DM		
14	Andrew Muehlig	-	12	D E		
15	Anemoneflora Rubra	1854	4	DM		
16	Archie Brand	1913	12	DM F		
18	Arlequin	-	3	J		
19	Arturus	-	4	S		
20	Asa Gray	1886	13	DM F		
22	Auguste Dessert	1920	17	DM		
23	Augustin d'Hour	1867	15	DM		
24	Aureolin	1917	22	J M VF		
25	Aurore	1904	19	DM		
26	Auten's Pride	1933	23	D L F		
27	Avalanche	1886	19	DM F		
29	Baroness Schroeder	1889	9	DM F		
30	Bayadere	1910	19	DM		
32	Belisaire	1901	13	DM		
33	Benjamin Franklin	1907	17	DM		
34	Bertrade	1909	20	D L		
35	Betty Blossom	1925	6	DM		
38	Blanche King	1922	26	DM		
39	Blanche Turner	-	22	D		
40	Boule de Neige	1867	8	DM F		
43	Celestial	-	25	S M		
44	Charles McKellip	1907	17	DM		
46	Cherry Hill	1915	16	D E		
47	Chestine Gowdy	1913	23	D L VF		
48	Claire Dubois	1886	24	D L		
49	Clairette	1905	1	S		
50	Claude Gellee	1904	20	D		
51	Clemenceau	1920	24	DM		
52	Constant Devred	1868	27	D		
53	Cornelia Shaylor	1919	21	D L		

Inv# / Name / Yr / Bed / Form / Season / Scent

54	Coronation	1902	14,15	D M F		
55	Couronne d'Or	1873	20	D L F		
56	David Harum	1907	26	DM		
57	Early Daybreak	1949	3	S M		
59	Departing Sun	1925	17	S M		
63	Duc de Wellington	1859	19	D F		
64	Duchess of Portland	-	2, 5	S		
65	Duchesse de Nemours	1856	1	D E F		
66	Duke of Devonshire	1895	26	D		
70	Edith Lyttleton	-	4	DM		
72	Edulis Superba	1824	4	D E VF		
73	Edwin C. Shaw	1919	12	DM VF		
74	Eileen Kelway	-	11	J		
75	Elfin Pink	1937	12	S E		
77	Elisa	1922	13	DM		
79	Ella Christiansen	1925	12	DM F		
80	Ella Christine Kelway	1899	11	D F		
81	Elwood Pleas	1900	21	D L		
83	Entente Cordiale	1917	22	D		
85	Etta	1904	22	D L F		
89	Eugenie Verdier	1864	12,14	DM F		
90	Euphemia	1920	14	D F		
92	Exquisite	1912	14	SDM		
93	Fanny Crosby	1907	9	D E		
94	Faribault	1918	25	D		
95	Faustine	1924	25	D		
97	Felix Crousse	1881	16	DM		
98	Ferdinand Stolickza	1904	1	D		
99	Festiva	1838	19	D F		
100	Festiva Maxima	1851	2	D E F		
102	Flag of War	1900	3	S		
104	Floral Treasure	1900	13	D L F		
105	Florence Nightingale	1907	18	D L		
107	Frances Willard	1907	7	DM F		
109	Frankie Curtis	1924	4	DM		
111	Fuyajo	-	16	J		
112	Galathee	1900	18	D L VF		
113	Geishe	1930	27	J		
115	Georgiana Shaylor	1908	14	DM F		
117	Gigantea	1860	21	DM F		

Inv# / Name / Yr / Bed / Form / Season / Scent

118	Ginette	1915	9	DM		
120	Gisele	1908	8	D		
123	Gloire de Touraine	1908	26	D		
124	Golden Dawn	1923	6	DM F		
125	Grace Loomis	1920	18	DL		
126	Grandiflora	1883	25	DL F		
127	Grandiflora nivea plens	1824	2	DEF		
128	Grover Cleveland	1904	26	DM		
130	H. A. Hagen	1904	24	DL VF		
131	H. F. Reddick	1913	17	D		
133	Hansina Brand	1925	22	DL		
136	Hazel Kinney	1925	2,25	DM		
137	Helen	1922	3	SE		
138	Helen Robertson	-	3	D		
139	Helen Wolaver	-	21	DL		
141	Henry Avery	1907	18	DL		
142	Henry M. Vories	1924	25	DL		
143	Hiscite Gawa	-	26	J		
145	Innocence	1904	22	JL		
146	Inspecteur Lavergne	1924	27	DM		
147	Isoline	1916	18	DM		
148	James Boyd	1919	20	DL VF		
149	James Kelway	1900	9	DM F		
150	James R. Mann	1920	14	DM		
151	Jeanne Gaudichau	1902	18	DL		
153	Jeannot	1918	21	DL		
155	John Richardson	1904	21	DL F		
156	Jubilee	1908	6	DM		
157	Judge Berry	1907	4	DE		
158	Jules Calot	1861	25	D		
160	Karl Rosenfield	1908	16	DM		
162	Katherine Havemeyer	1921	10	DM F		
163	Kelway's Glorious	1909	5	DM F		
164	Kelway's Queen	1909	13	DM VF		
165	King of England	1902	15	JM		
166	Krinkled White	1928	1	SM		
167	L'Etincelante	1905	13	SM		
169	La Fiancee	1898	8	D		
171	La France	1901	25	DL F		
172	La Lorraine	1901	6	DM		
173	La Perle	1886	14	DM F		

Inv# / Name / Yr / Bed / Form / Season / Scent

174	La Rosiere	1888	8	SDM		
175	La Tendresse	1896	7	DM F		
176	La Tulipe	1872	7	DM F		
177	Lady Alexandra Duff	1902	10	DM F		
179	Lady Emily	1807	10	DM		
180	Lady Kate	1924	24	DL		
182	Lamartine	-	17	D F		
183	Laura Dessert	1913	1	DM		
184	Le Cygne	1907	6	DEF		
185	Le Jour	1915	1,2	SM		
186	Livingstone	1879	24	DL		
187	Longfellow	1907	15	DM		
188	Lora Dexheimer	1913	4	DM		
189	Lord Kitchener	1916	5	DM		
190	Louisa Brand	1913	18	DL		
191	Loveliness	1907	23	DL		
192	Lucy E. Hollis	1907	22	DM		
193	Luella Shaylor	1917	6	DM		
194	Luetta Pfeiffer	1916	1	DEF		
195	Mable L. Franklin	1920	15	DM		
196	Madelon	1922	18	DL		
198	Marechal Vaillant	1867	27	DM		
202	Marguerite Gaudichau	1903	22	DL F		
203	Marguerite Gerard	-	23	DM		
204	Marie	1868	19	DL F		
205	Marie Crousse	1892	14	DM F		
206	Marie d'Hour	1883	9	DM		
207	Marie Jacquin	-	10	SDM VF		
208	Marie Lemoine	1869	20	DL VF		
209	Marquis C. Lagergren	1911	17	DM		
210	Martha Bulloch	-	24	D F		
212	Mary Brand	-	17	D		
214	Mary Woodbury Shaylor	1916	9	DM F		
217	Maud L. Richardson	1904	23	DL VF		
219	Meteor	1933	4	J		
222	Mignon	1908	13	DM VF		
223	Mikado	1893	17	JM		
224	Mildred May	1943	8	SDM		
225	Milton Hill	1891	21	DL		
227	Miriam	1916	24	DM		

Inv#	Name	Yr	Bed	Form	Season	Scnt
228	Mischief	1925	27	S	L	
229	Miss Salway	1905	11	D	M	F
230	Mlle. Jeanne Riviere	1908	11	D	M	
234	Mme. Auguste Dessert	1899	12	D	M	
235	Mme. Benoit Riviere	1911	24	D	M	
236	Mme. Boulanger	1886	22	D	M	
238	Mme. Calot	1856	1	D	E	F
239	Mme. Camille Bancel	1897	27	D	M	
244	Mme. de Verneville	1885	11	D	E	F
245	Mme. Ducel	1880	4	D	M	F
246	Mme. Emile Galle	1881	22	D	L	F
247	Mme. Emile Lemoine	1899	6	D	M	F
248	Mme. Forel	1887	25	D	M	
250	Mme. Gaudichau	1902	27	D	M	
252	Mme. Guyot	-	7	D	M	
253	Mme. Joanne Sallier	-	3	D	M	
254	Mme. Jules Dessert	1909	11	D	M	
256	Mme. Lemoinier	1865	10,11	D	M	
258	Mme. Savreau	1906	9	D	M	
261	Mons. Depont	1872	8	D	M	VF
262	Mons. Jules Elie	1888	4	D	E	F
263	Mons. Martin Cahuzac	1899	16	D	M	
265	Moon of Nippon	1936	19	J		
266	Moses Hull	1907	13	D	M	
267	Mr. G. F. Hemerik	-	24	J		
268	Mr. L. vanLeeuwen	1916	26	D	M	F
269	Mr. Thim	1926	3	S	E	
271	Mrs. A. M. Brand	1925	19	D	L	F
273	Mrs. C. S. Minot	1914	23	D	L	
274	Mrs. Edward Harding	1918	7,8	D	M	
275	Mrs. F. D. Roosevelt	1932	24	D	M	
278	Mrs. John M. Kleitsch	1925	24	D		
281	Mrs. Livingston Farrand	1935	15	D	M	
282	Myrtle Gentry	1925	21	D	M	F
284	Nanette	1924	2	D	M	
287	Nick Shaylor	1931	21	D	L	
289	Nippon Brilliant	1933	26	J	L	
291	Nymphaea	1919	6	D	M	
292	Octavie Demay	1867	3	D	E	
296	Opal	1908	11	D	M	
297	Pallas	-	9	S	D	M

Inv#	Name	Yr	Bed	Form	Season	Scnt
298	Paradise	1907	11	D	M	
299	Pasteur	1896	9	D	M	
301	Petite Renee	1899	16	J	M	
302	Philippe Rivoire	1911	8	D	E	VF
303	Philomele	1861	10	E	F	
304	Pheobe Cary	1907	23	D	L	F
305	Phyllis Kelway	1908	10	S	D	M
306	Pico	1934	1,2	S	M	
308	Pink Baroness Schroeder	-	12	D		
309	Pink Delight	-	3			
312	President Lincoln	1928	27	S	M	
313	President Wilson	1918	23	D	L	F
314	Pride of Essex	1916	12	D	M	
315	Primevere	1907	7	D	M	F
317	Princess Irene	1889	10,15	D	M	
319	Queen of the Belgians	-	7	S	M	
320	R. P. Whitfield	1904	23	D	L	F
322	Rachel	-	15	D		
324	Rei-Kai-Zan	-	10	J		
325	Reine Hortense	1857	14	D	M	
326	Richard Carvel	1913	4	D		
327	Richardson's Perfection	1869	20	D	M	
328	Rinhosen	-	21	J	M	
330	Rosa Bonheur	1905	10	D	L	F
332	Rose Shaylor	1920	6	D	M	
333	Rosette	1918	14	D	M	
334	Rosy Dawn	-	12	S	E	
335	Rubra Superba	1871	26	D	L	F
336	Ruth Brand	1907	13	D	M	
338	Sarah Bernhardt	1906	15	D	L	F
339	Sarah Carstensen	1901	14	D	M	
340	Sarah K. Thurlow	1921	21	D	L	VF
341	Secretary Fewkes	1917	7	D	M	F
344	Simonne Chevalier	1902	3	D	M	F
346	Solange	1907	21	D	L	
348	Some Ganoko	-	8	J	M	VF
351	Souv. de Louis Bigot	1913	16	D	M	F
353	Splendida	1850	25	D	L	F
354	Standard Bearer	1906	3	D	E	VF
356	Summer Day	1895	1	D	M	
359	Suzette	1911	12	D	M	

Inv#	Name	Yr	Bed	Form	Season	Scent
360	Sylviane	1924	18	D	M	
361	The Moon	-	5	S	M	
363	Therese	1904	14	D	M	
365	Tokio	-	17	J	M	
366	Tourangelle	1910	11	D	L	
368	Triomphe de l'Exposition de Lille	1865	11	D	M	
369	Umbellata Rosea	1895	5	D	E	
370	Venus	1888	9	D	M	F
371	Victorie de la Marne	1915	16	D	M	
372	Victory Chateau Thierry	1925	-3	D	M	
375	W. F. Christman	1921	20	D	M	F
376	Walter Faxon	1904	14	D	M	
377	Walter Morgan	1900	2	D	M	
378	Welcome Guest	1904	10	D	M	
379	White Lady	1900	18	J	M	
380	Will McClelland	1919	13	D	M	
381	William F. Turner	1916	15	D	M	
384	Winifred Domme	1913	16	D	M	
385	Winnikenni	1915	27	D	L	
386	Yeso	-	22	J	M	
387	Westerner	1942	15	J	M	

History of Nichols Arboretum

Nearly 90 years ago the Arboretum was established with a gift 27.5 acres of farm land from Dr. Walter H. and Esther Connor Nichols, U of M alumni. In 1906, Prof. Frederick C. Newcombe made this case to the Regents:

"In this University we have been able to work without a botanic garden, because we have been able to use the whole surrounding country for our field of study. But one can foresee that in twenty-five years the farmers' woodlots will be put under cultivation for timber, the bogs will be drained, and no land will be left where vegetation can be studied in natural conditions. The land of the proposed donation is ideal for the purpose of bringing together in a small area all the vegetation of this climate, giving to each plant society its characteristic conditions. The tract is made up of hills, ravines, level low land, a bog, and a rivulet. The northern part is sand, and the southern heavy clay."

Newcombe and botany professor George P. Burns, Ann Arbor Park Commissioner, negotiated a joint operating agreement between the City and the University to develop City land along the river and the Nichols Farm as one piece. They envisioned University and City schools being the primary users.

In 1906, the farm field that would become Nichols Arboretum was plotted by Ossian Cole Simonds, a U of M-educated civil engineer and a notable landscape gardener with his own firm in Chicago. Simonds is credited with laying out the basic design of the Arboretum with its hill-hugging roads, broad expanses of lawn, "rooms", and scenic views.

Friends of Nichols Arboretum

Organized in 1988, the Friends grew to 250 members during its Charter Year of 1991-92, and now has more than 500 members.

Friends' projects that support the Arboretum's educational mission and raise funds include:

- Newsletter, *TreeLine*
- Docent training and tours
- Arb Gear: t-shirts, sweatshirts, etc.
- Events: Fall Gathering, Peony Garden Party, Arbor Week Observance
- Educational displays
- Work Days
- Speakers' Bureau

Mission of the Friends

The mission of the Friends organization is to stimulate interest in the education and research aspects of natural resource conservation and ecology at Nichols Arboretum; to assist the Arboretum in developing both its public and educational roles; and to financially support the development of the Arboretum and its mission.

How to Join the Friends

If you would like to become a member of the Friends, please fill out the enclosed form, make a check payable to the University of Michigan, and mail to:

Nichols Arboretum
University of Michigan
3012D Dana Bldg.
Ann Arbor, Michigan 48109-1115

For information, call Elizabeth Elling, Development Officer, at 313-763-5832.

How to Order this Guide

Write to the above address, or call 313-763-5832 for details.

Mission of Nichols Arboretum

Nichols Arboretum, operated by the School of Natural Resources and Environment, sets forth as its mission to heighten the awareness of human relationships with the environment by considering issues of renewable natural resources conservation and by the development of an outstanding and diverse collection of the world's temperate zone plants, demonstrated by the conservation and restoration of individual plants, plant communities, and their habitats. To accomplish this mission, the Arboretum shall promote education and research projects that promote the botanical and design aspects of plants which benefit students of the University of Michigan and Ann Arbor schools, Michigan residents, and the world's citizens.

Adopted 11-2-88

Staff and Committees

Nichols Arboretum Staff

Harrison L. Morton, *Director*

Elizabeth M. Elling, *Development Officer*

Gwen Christensen, *Secretary*

Guy Smith, *Curator, Docent Coordinator*

Jeff Walters, *Groundsman*

Joe Howard, *Management Intern / Caretaker*

Nadir Ait-Laoussine, *Management Intern /
Caretaker*

Friends' Officers and Directors, 1994-1995

Paul Bairley, *President*; Donald Wortman, *Treasurer*;

Dea Armstrong, Charles Cares, Joan Kobrinski,

Trudy Bulkley, Donald Gray, Guy Smith, Raven

Wallace, Ruth Watts, Jack Weidenbach, Guerin

Wilkinson

Peony Garden Party Committee, 1995

Allison Arscott, *Chair*; Allison Adams, Paul Bairley,

Diane Baker, Ann Betz, Charles Cares, Celia

Copeland, Cecily Donnelly, Carolyn Larime,

Elizabeth Elling, Dino Lekas, Pat Materka, Jan

Onder, Mike Psarouthakis, Ligia de Reynolds, Mike

Schroer, Elaine Sims

Peony Garden Guide Committee, 1995

Allison Arscott, Diane Baker, Charles Cares, Cecily

Donnelly, Elizabeth Elling, Edward Fead, Dino

Lekas, Guy Smith, Patty Schwarz

Regents of the University of Michigan

Deane Baker, Laurence B. Deitch, Daniel D.

Horning, Shirley M. McFee, Rebecca McGowan,

Andrea Fischer Newman, Philip H. Power, Nellie M.

Varner, James J. Duderstadt, *President, University
of Michigan*

The University of Michigan, as an equal opportunity affirmative action employer, complies with all applicable federal and state laws regarding nondiscrimination and affirmative action, including Title IX of the Education Amendments of 1972 and Section 504 of the Rehabilitation Act of 1973. The University of Michigan is committed to a policy of nondiscrimination and equal opportunity for all persons regardless of race, sex, color, religion, creed, national origin or ancestry, age, marital status, sexual orientation, disability, or Vietnam-era veteran status in employment, educational programs and activities, and admissions. Inquiries or complaints may be addressed to the University's Director of Affirmative Action and Title IX/Section 504 Coordinator, 6041 Fleming Administration Building, Ann Arbor, Michigan 48109-1340, (313) 763-0235, TDD (313) 747-1388, FAX (313) 763-2891.

Location of the Arboretum

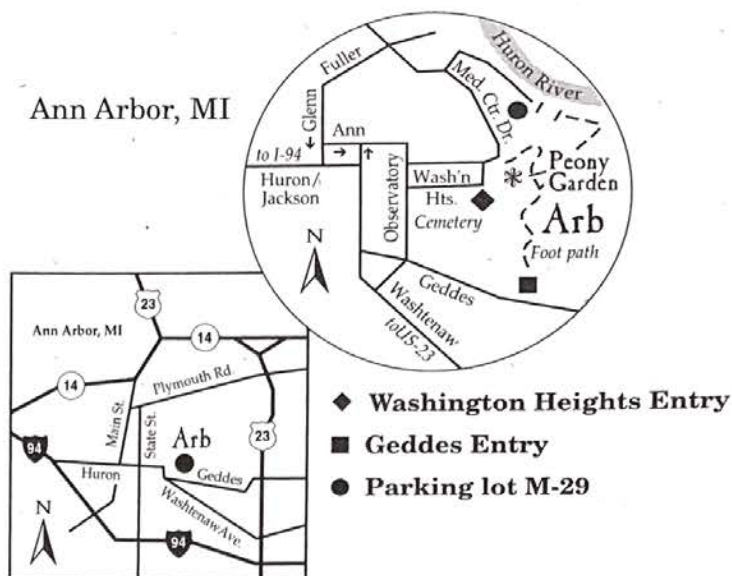

Directions

From I-94: Take US-23 north (see map).

From US-23: Take Washtenaw Ave. west or Geddes Ave. west, turn right onto Observatory St., then right onto East Medical Center Drive to Hospital Parking Lot M-29 (weekend only). On weekdays, continue on East Medical Center Drive to U of M Hospital visitor parking structures. Pedestrians may use the Geddes Ave. or Washington Heights Arboretum entrances.

Nichols Arboretum is open daily sunrise to sunset. Admission is free. Please call 313-747-0520 for information about group tours.

Printed on recycled paper:
50% recycled fiber including
10% post-consumer waste





NICHOLS ARBORETUM

University of Michigan
School of Natural Resources and Environment
3012D Dana Building Ann Arbor, MI 48109-1115
313-763-5832